

符合RoHS环保要求

版次REV.	日期 DATE	变更内容 DESCRIPTION	审核CHK.	核准APPD.
A0	2023-06-25	新图面发行	TXH	YHG

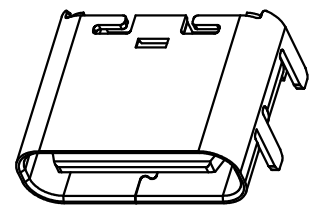

RECOMMENDED P.C.B. LAYOUT  
TOLERANCE UNSPECIFIED ±0.05mm

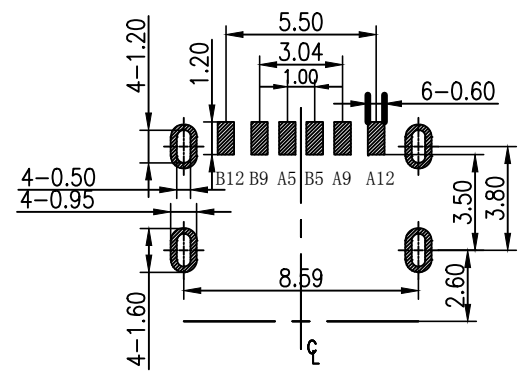
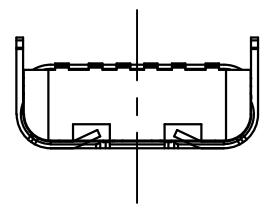
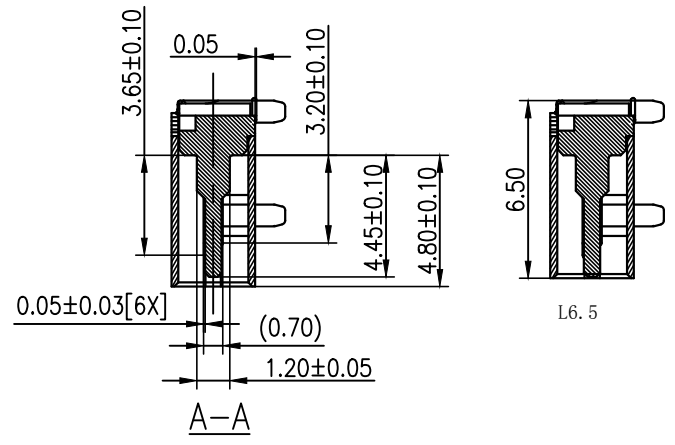
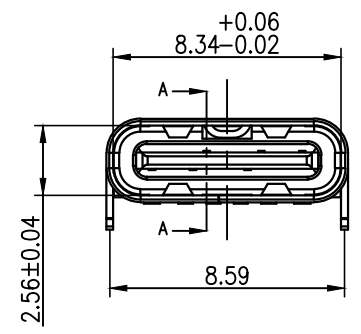
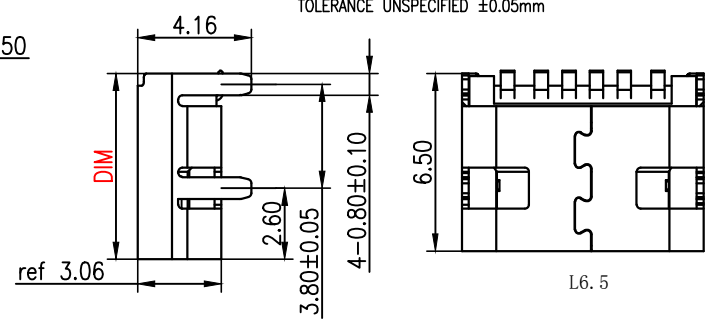
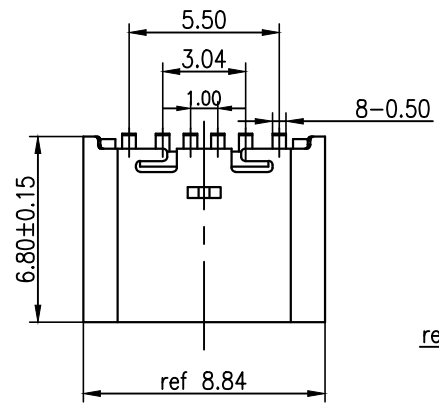

NOTE:

- MATERIAL SPECIFICATION:
  - HOUSING: HIGH TEMPERATURE RESISTANT PLASTIC, UL94 V-0.
  - CONTACTS: COPPER ALLOY
  - SHELL: STAINLESS STEEL
  - HOOK: STAINLESS STEEL
- PLATING SPECIFICATION:
  - CONTACTS:
    - Ni 30u" MIN. UNDER PLATED OVER ALL.
    - Au PLATED ON THE FUNCTIONAL AREA OF CONTACT. (GOLD PLATING THICKNESS FOLLOW THE P/N)
  - SHELL:
    - Ni 30u" MIN. UNDER PLATED OVER ALL.
- MECHANICAL PERFORMANCE,
  - INSERTION FORCE: 0.5~2.0kgf.
  - REMOVAL FORCE: 0.8kgf~2.0kgf.
- ELECTRICAL PERFORMANCE,
  - CURRENT RATING: 3.0A  
VOLTAGE RATING: 5.0V
  - INSULATION RESISTANCE: 100MΩ MIN
  - DIELECTRIC WITHSTAND VOLTAGE, AC100V FOR 1MINUTE.
- ENVIRONMENTAL PERFORMANCE:
  - OPERATING TEMPERATURE: -30°C~+80°C.
- IR REFLOW:
  - THE PEAK TEMPERATURE ON THE BOARD SHALL BE MAINTAINED FOR 10 SECONDS AT 260°C.

料号	品名规格	DIM
	6P 板上L=6.8 带中夹片	6.80
	6P 板上L=6.5 带中夹片	6.50

一般公差 GENERAL TOLERANCE	
X.X ±0.20	X° ±2°
X.XX ±0.15	X.X° ±1°
X.XXX ±0.10	X.XX° ±0.5°
单位 UNIT	mm

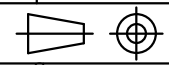

绘图 DR.		品名 TITLE TYPE C 6P母座 板上SMT带中夹片 L=6.8/6.5
审核 CHK.		
核准 APPD.		

图号 DRAWING NO.		
文件编号 NUMBER		
比例 SCALE 1:1	SHEET 1/1	版次 REV. A0